

### Specification

Door Operator (Qty)	DH-41 (one unit)	DH-41 (Two unit)	DH-41 (one unit)
Opening Method	Double swing (Two leaves, 90 degrees)		Single swing (One leaf, 90 degrees)
Applicability	Applicable Door Mass x Door d'ty	100x2	104x2
	Door width: DW (mm)	750~990	990~1100
Average speed	~45°/s		
Power supply	100VAC·5A	100VAC·10A	100VAC·5A
Maximum Operable Wind Speed	10m/s or less		

### Notice

1. All drawings herein are subject to change without notice.
2. For further details, please contact NABCO sales distributors.

Drawing of DH-41 Door Operator  
Swing Door (Elevation)  
Scale 1:20

改訂No.	改訂日時
番号 No.	
1HP111504-01	
<b>Nabtesco</b> Nabtesco Corporation	

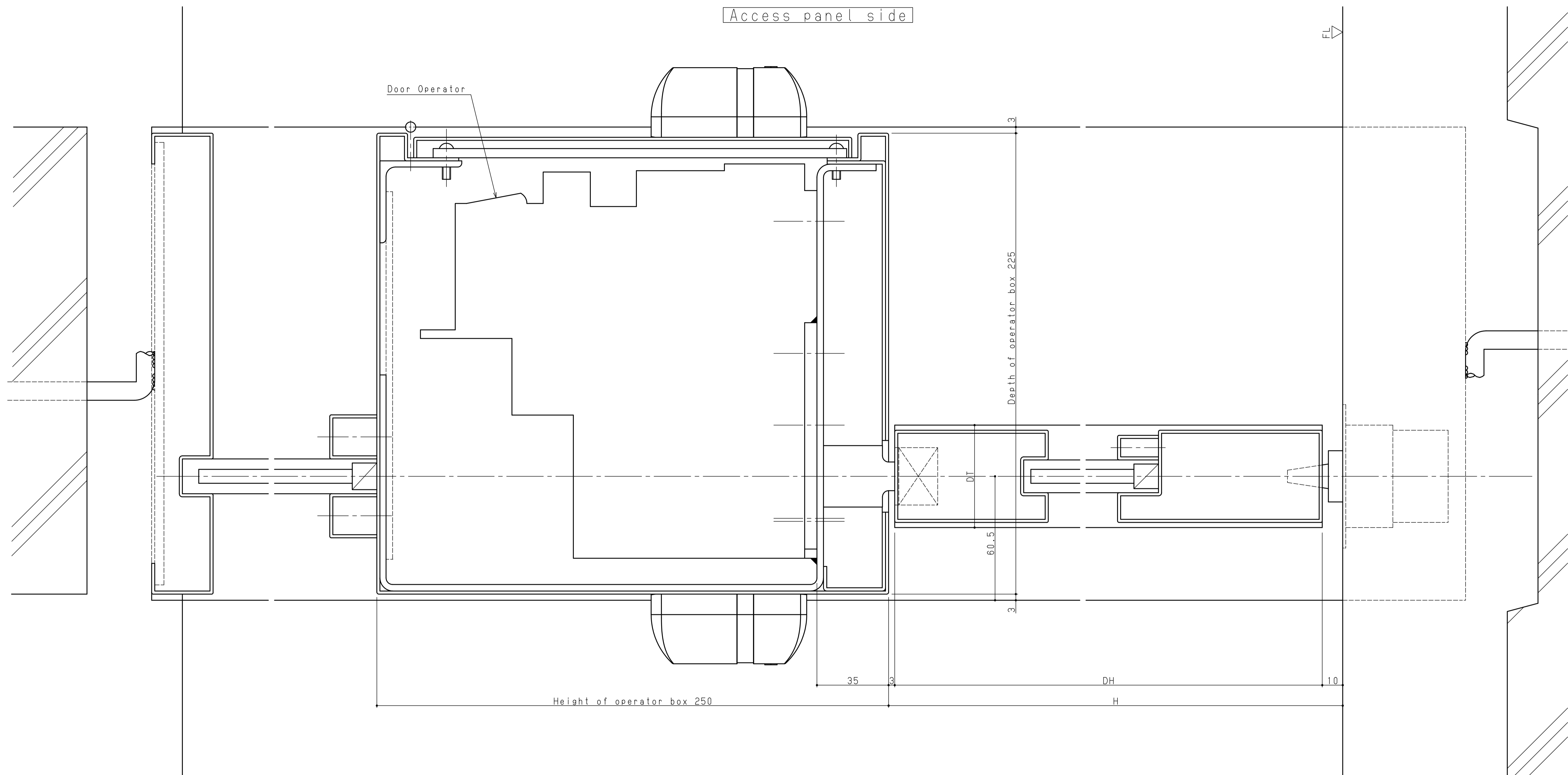

Notice

- 1. All drawings herein are subject to change without notice.
- 2. For further details, please contact NABCO sales distributors.

Drawing of DH-41 Door Operator  
 Swing Door  
 (Section)  
 Scale 1:1

改訂No.	改訂日時
番号 NO.	
1HP111504-02	
<b>Nabtesco</b> Nabtesco Corporation	

参考図書