

PL-1U PULLEY LOCK

Features

PL-1U is the electrical locking / unlocking device with the built-in electro magnetic lock within the idler pulley, which seizes a driving belt secured to door panel.

Simple installation by replacing PL-1U with an existing normal idler pulley

The installation dimensions are nearly same with those of normal idler pulleys.

Simple mechanism ensures locking / unlocking operations

Fail-safe lock condition enables it to unlock by turning off the power of automatic sliding door.

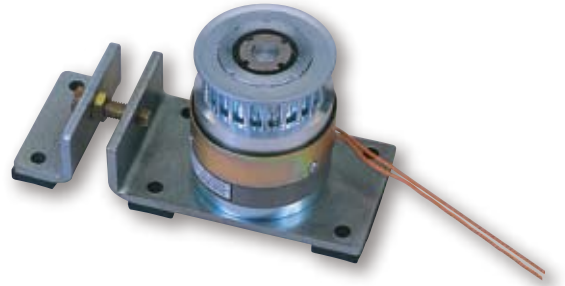

Specification

PL-1U PULLEY LOCK	
Lock Type	Fail-safe (Unlock at power off)
Hold-Locking Force	Approx. 800N
Mounting	Replaced with idler pulley
Remarks	To be used with Pulley Lock controller

Reference drawing

Dimensions (mm)

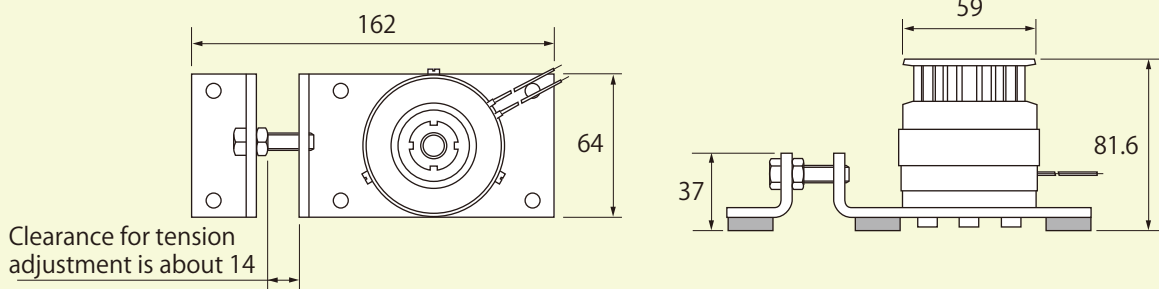

Mass : 1,300g